

REPLACEMENT RETARD/ SWITCH ASSEMBLY

Contact Ratings: Two sets of SPDT (Form C)
10.0 Amps of 125/250 VAC
1.0 Amps at 30 VDC resistive

Usage: Replacement retard/switch assembly for use on Potter VSR Series flow switches.

Removing The Existing Retard/Switch Assembly

Remove the 2 screws holding the retard/switch assembly to the VSR base. Pull the retard assembly straight up.

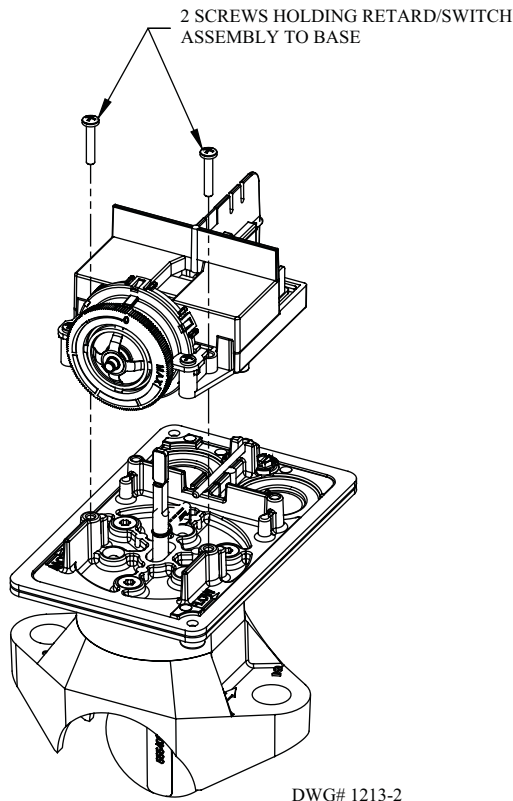

Installing Replacement Retard Assembly

Ensure the 2 locating pins on the bottom of the retard assembly are in the proper location on the VSR base. Re-install the mounting screws attaching the retard assembly to the base.

